

DIRECTION 155

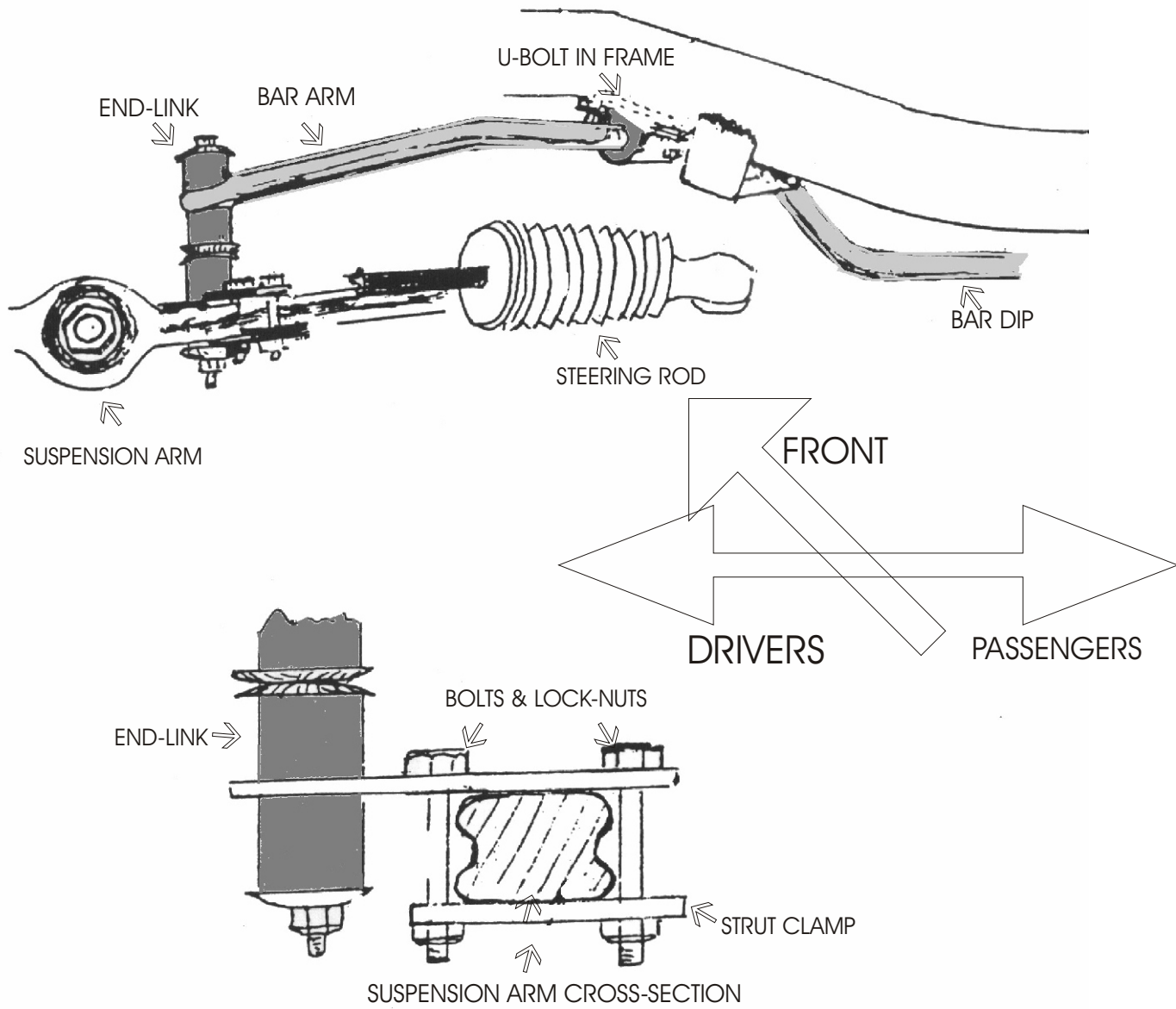

Directions #155

- Step #1.** Place suspension arm clamps on front of suspension arms with the large holes to the front. Loosely secure with bolts. Move clamps as far out as possible to where arms widens at the strut connection. Tighten nuts.
- Step #2.** Position bar under car so mid-section is to rear of the front wheels, and the arms come forward over the steering rods and the eyes center directly over the large hole in the mounting plates. Tie mid-section of bar up with string to facilitate work.
- Step #3.** Assemble end-links as detailed.
- Step #4.** Place the "D" shaped rubber bushings on the bar near shoulder flat side facing frame bottom. Raise bar mid-section so bushings rest against frame, cover with frame bracket holes. Drill frame bottom with a 3/8" drill bit, using the frame bracket holes as a template.
- Step #5.** Secure frame bracket, bar and bushing to the frame bottom. Be sure to keep a nut on the U-bolt all the time when inserting it into the frame so it cannot get lost within. (See diagram for insertion of U-bolt.)
- Step #6.** Check all fastenings for suitable tightness. Clamps should be tightened to 20 ft/lbs, and the U-bolt to 10 ft/lbs. The end-links should only just be snug. Have someone bounce the front of the car so you can check clearance between the unit and other parts; steering rod, exhaust, etc. throughout the suspension travel distance.
- Step #7.** Road test vehicle and accustom yourself to your cars new handling. As we cannot supervise your installation or driving, we cannot be responsible for more than the cost of the kits.

IMPORTANT NOTE: As this unit does not replace the existing strut rod it is not necessary to have the front end realigned; furthermore, this unit reduces the stress on the critical strut/suspension arm connection instead of increasing the stress at this point.

HARDWARE

2	RH 507 Bushings
2	RH 013 End-Links
8	RH 104 Flat Washers
4	RH 206 Bolts
2	RH 402 U-Bolts
8	RH 304 Lock-Nuts
2	RH 040 Frame Brackets
2	RH 058 Arm Clamps
2	RH 059 Arm Clamps