

# DIRECTION 444

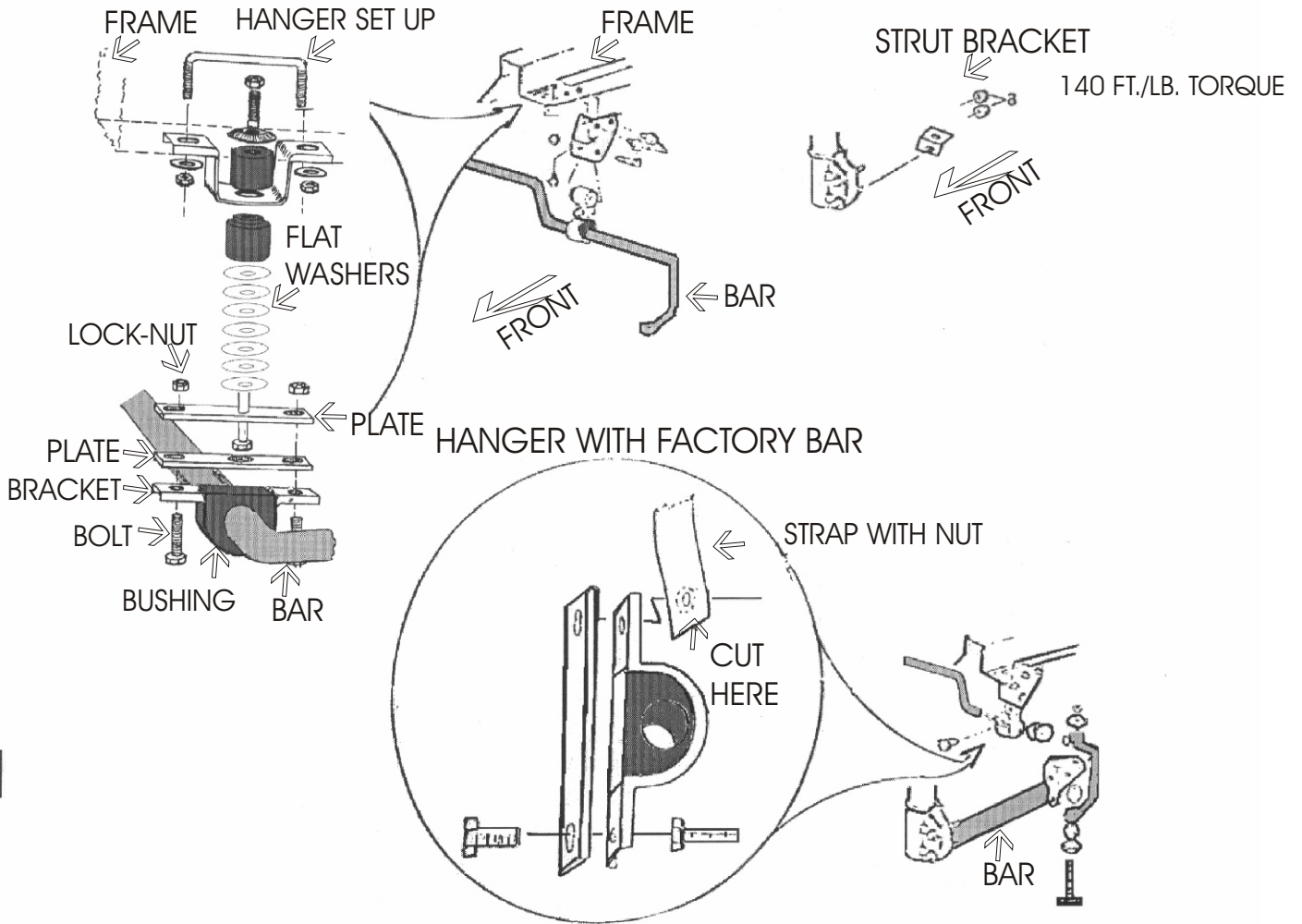

## HOW TO INSTALL A U-BOLT

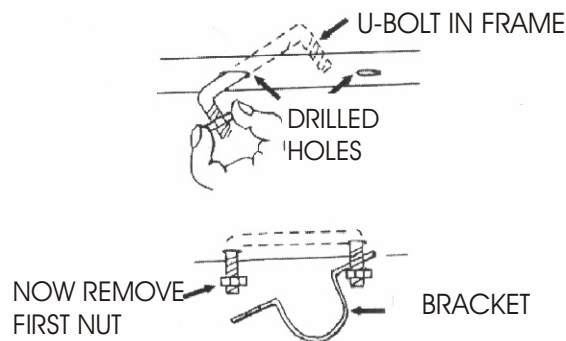

## DIRECTIONS 444

- NOTE:** On cars that are equipped with a factory rear bar, the mounting hardware on the rear struts is used for the new bar. The frame hangers can also be used with modifications or replaced with the hardware supplied.
- STEP #1.** Remove the factory bar if the car was equipped with one. Retain the factory mounting hardware for use with the new bar. The factory uses a metal strap with a nut welded to it, to hang the bar from the frame. This strap can be modified as follows for re-use with the new bar. Cut the loops off of the strap just below the welded nuts. Mount the D-bushing bracket and support plate to strap using the welded nut and the factory bolt as shown. **NOTE:** Steps 2 and 4 can be skipped if your car had a factory installed rear bar.
- STEP #2.** Install the angle brackets on the lower of the two mounting bolts on the struts as shown.
- STEP #3.** Fish the bar, arms forward and dip up, over the exhaust pipe. Disconnecting an exhaust hanger will make this step easier. Attach the ends of the bar to the angle brackets on the struts using the end-link assemblies as shown.
- STEP #4.** Assemble the frame hangers to the bar's center section as shown hold the hangers up to the frame so that the end-links and hangers are not in a bind. The wheels should not be allowed to hang during this operation. Mark the frame through the holes in the hanger bracket. Drill two 3/8" holes the same distance apart as the legs of the square U-bolt. **ALWAYS USE EYE PROTECTION WHEN USING A DRILL.** Install a nut on one leg of the square U-bolt and thread the other in one hole, and out the other. Remove the nut and install the hanger onto the legs of the U-bolt as shown. Repeat this process for the other side.
- STEP #5.** Tighten all fasteners to 15-20 ft/lb. Tighten the end-links and hanger center bolts so that the bushings just deform slightly.
- STEP #6.** Road test your car to familiarize yourself with its new handling. As we cannot supervise your installation or your driving we cannot be held responsible for more than the cost of the kit.

### HARDWARE:

2 RH 019	End-Links
4 RH 500	Bushings
4 RH 109	Cupped Washers
2 RH 034A	Plates
2 RH 034B	Plates
2 RH 040	Brackets
2 RH 041	Brackets
2 RH 024	Angles
2 RH 207	Bolts
4 RH 214	Bolts
10 RH 304	Lock- Nuts
18 RH 104	Washers
2 RH 402	U-Bolts
2 RH 508	Bushings