

DIRECTION 461 TROOPER-REAR

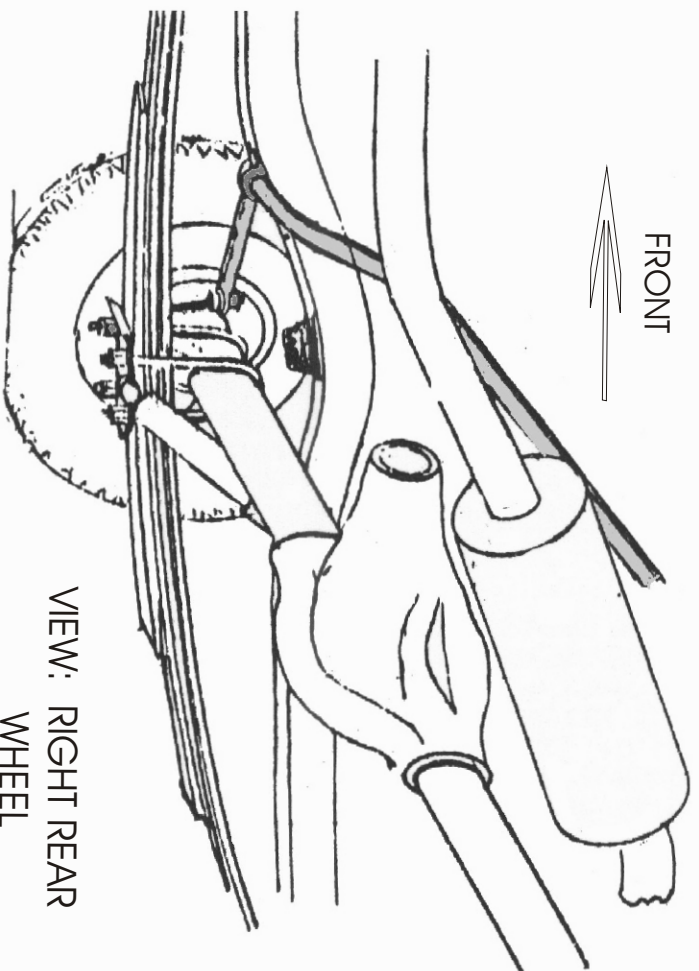

VIEW: RIGHT REAR
WHEEL

U-BOLT DETAIL

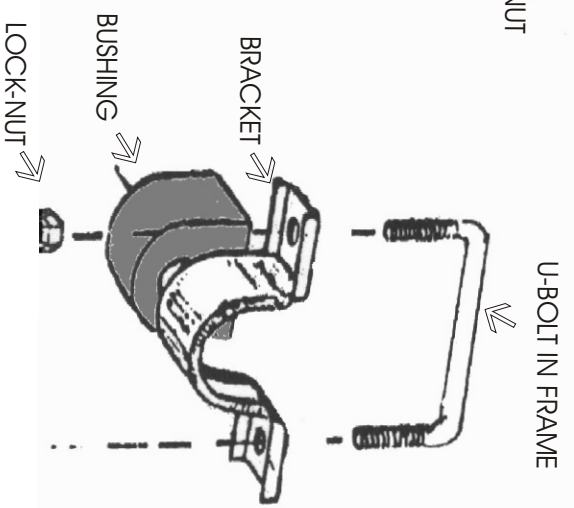
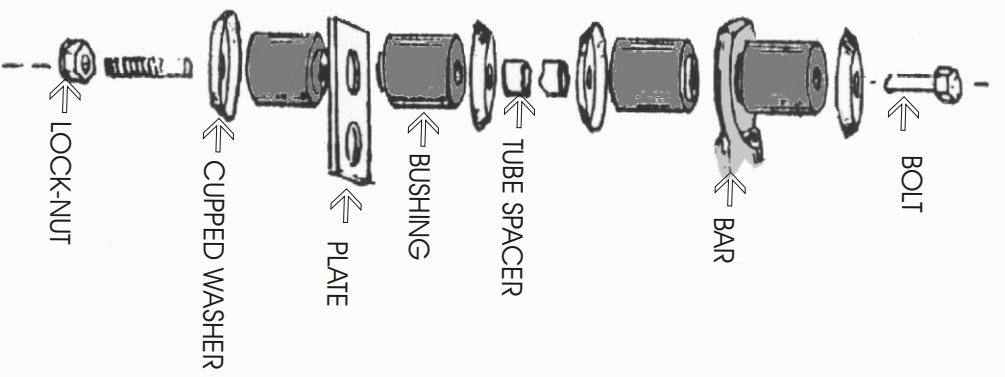

DIRECTIONS 461

- STEP #1.** Pass the bar over the drive shaft and muffler. Arms should be to the rear, dip up.
- STEP #2.** Place a lock-nut on one leg of the square U-bolt and insert the other end into the most forward hole in the bottom side of the frame where it slopes upward in front of the axle. Maneuver it until it reappears through the third hole from the front. Place the bar bracket hole on it and start the lock-nut. Repeat on the other side.
- STEP #3.** Place the D-bushings on the bar mid-section near the bends and place bushings within the bar brackets. Remove the first lock-nut from the U-bolts and position the other end of the bar bracket on them and replace the lock-nut. Tighten horizontal towards the rear.
- STEP #4.** Remove the outer forward nut on the bottom of the U-bolts that attach the springs to the axle. Place the hole in the mounting plate on the U-bolt leg and replace the nut securely. With the plate pivoted slightly forward. Repeat on the other side.
- STEP #5.** Assemble end-link so as to connect the bar eye and the outer hole in the mounting plate in the manner illustrated. Make sure that the trooper is resting evenly on its springs as you do this. Tighten the assembly only enough to keep it snug.
- STEP #6.** The installation is now complete. Bounce the rear of the vehicle to be sure that all parts clear throughout the suspension travel distance. Road test the vehicle to accustom yourself to its new handling. As we cannot supervise your installation or driving, we cannot be responsible for more than the cost of the kit. Note: For best balance, flatter cornering, and steadiest highway tracking, this kit should be used in conjunction with our front bar.

HARDWARE

2 RH 046	Brackets
2 RH 508	Bushings
2 RH 402B	U-Bolts
2 RH 017	End-Links
2 RH 032B	Plates
4 RH 304	Lock-Nuts
4 RH 104	Washers